



2412 N Robinson Ave

2412 N Robinson Ave, Oklahoma City, OK 73103



Dustin Eller

OKRE Commercial Advisors

1125 W Highway 152, Mustang, OK 73064

dustineller@okreca.com

(405) 445-7528



2412 N Robinson Ave

Upon Request

This property is located in the heart of the Uptown Revitalization District and just steps from the upcoming Starbucks at the hard corner of 23rd & Robinson. Surrounded by restaurants, live music venues, arts in the Paseo District, bars and the famous Tower Theatre with easy access to I-235 and just minutes from downtown....

This property is located in the heart of the Uptown Revitalization District and just steps from the upcoming Starbucks at the hard corner of 23rd & Robinson. Surrounded by restaurants, live music venues, arts in the Paseo District, bars and the famous Tower Theatre with easy access to I-235 and just minutes from downtown....

- Heavy foot traffic, high car counts and public transportation
- Floor to ceiling glass front with drive in roll up or dock high doors
- Exposed brick and ceiling



Price:	Upon Request
Property Type:	Retail
Property Sub-type:	Storefront Retail/Office
Building Class:	C
Sale Type:	Investment or Owner User
Lot Size:	0.16 AC
Gross Leasable Area:	7,000 SF
No. Stories:	1
Year Built:	1925
Tenancy:	Multiple
Parking Ratio:	0/1,000 SF
Clear Ceiling Height:	14 FT
No. Dock-High Doors/Loading:	1
APN / Parcel ID:	046600260
Walk Score ®:	70 (Very Walkable)

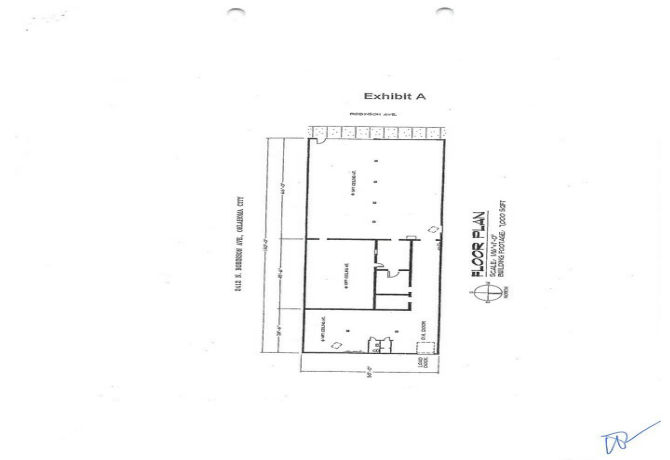

Major Tenant Information

Tenant	SF Occupied	Lease Expired
PHC Custom Cabinets	7,000	



2412 N Robinson Ave, Oklahoma City, OK 73103

This property is located in the heart of the Uptown Revitalization District and just steps from the upcoming Starbucks at the hard corner of 23rd & Robinson. Surrounded by restaurants, live music venues, arts in the Paseo District, bars and the famous Tower Theatre with easy access to I-235 and just minutes from downtown.

Property Photos



Building Photo



Building Photo